

# COMO REPARAR UNA CASA DE LADRILLO.

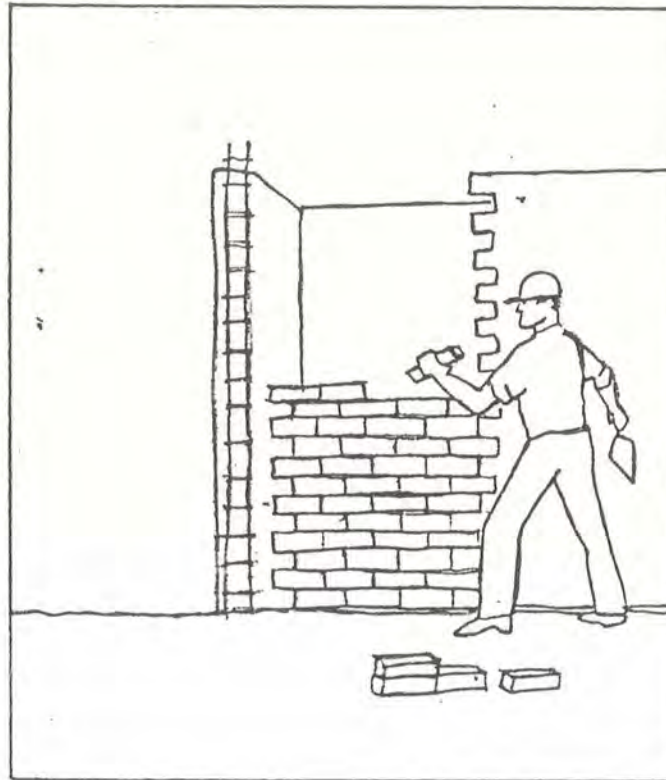

SENA

Programa de Reconstrucción



## REGLAS PARA REPARAR UNA CASA

1. DESARME DE ARRIBA HACIA ABAJO,
2. REPARE DE ABAJO HACIA ARRIBA
3. SIEMPRE quite el techo si no hay viga de amarre
4. SIEMPRE añada una viga de amarre en la parte superior
5. SI LA PARED ESTÁ DAÑADA MAS DE UN 25%, RECONSTRUYA LA PARED ENTERA.
6. GUARDE LOS MATERIALES QUE PUEDAN SER REUTILIZADOS

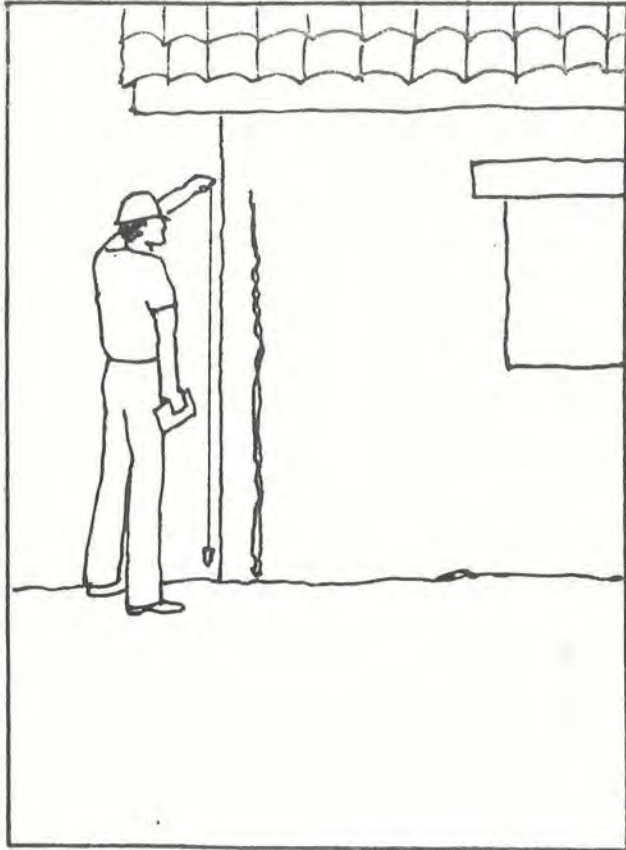

INSPECCIONE LA CASA

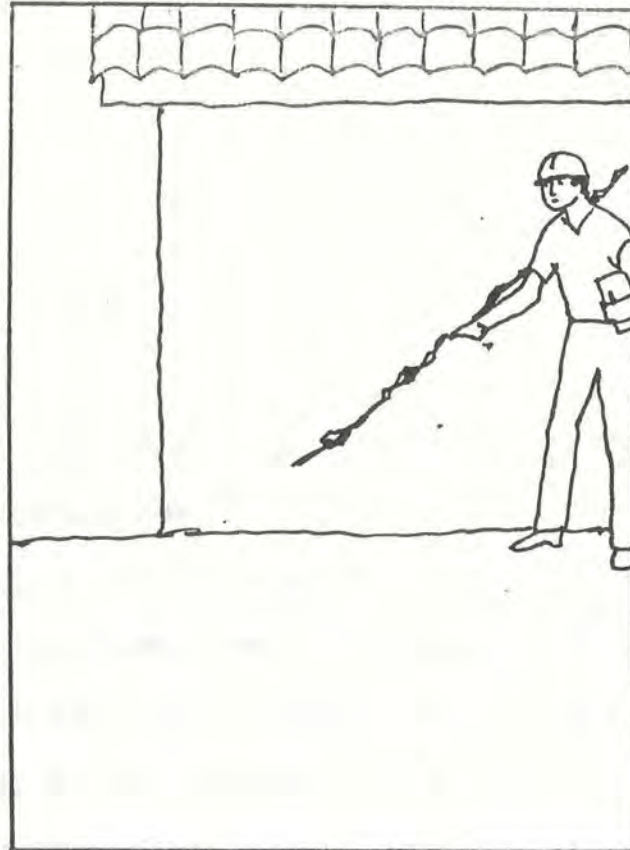

IDENTIFIQUE LA FALLA

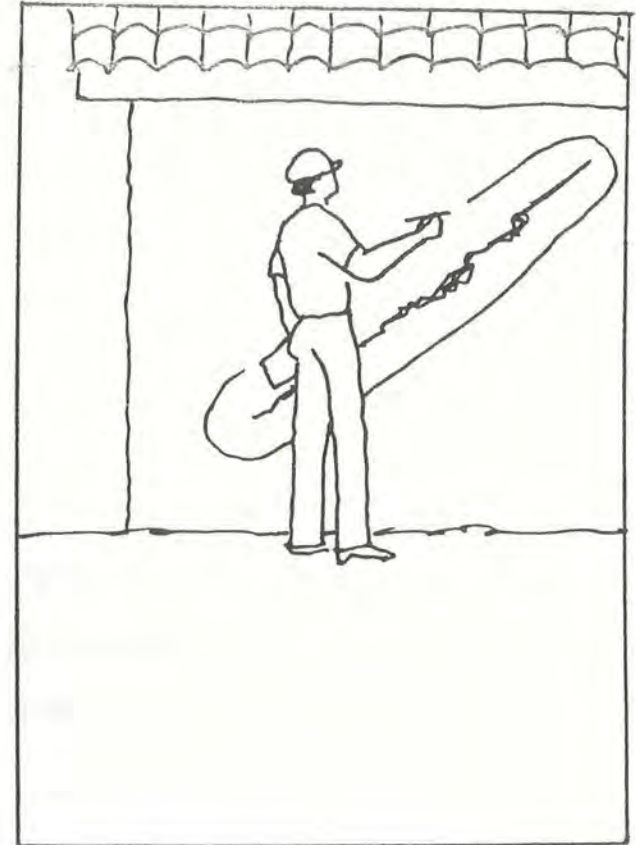

MARQUE EL AREA A SER RECONSTRUIDA



BAJE LAS TEJAS

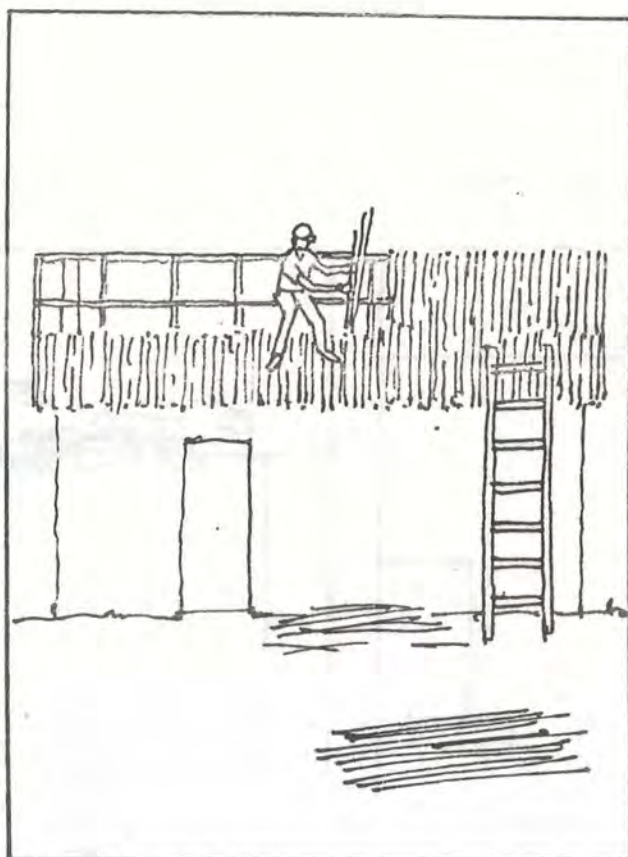

QUITE LAS CAÑAS



QUITE LAS MADERAS



TUMBE LA CULATA

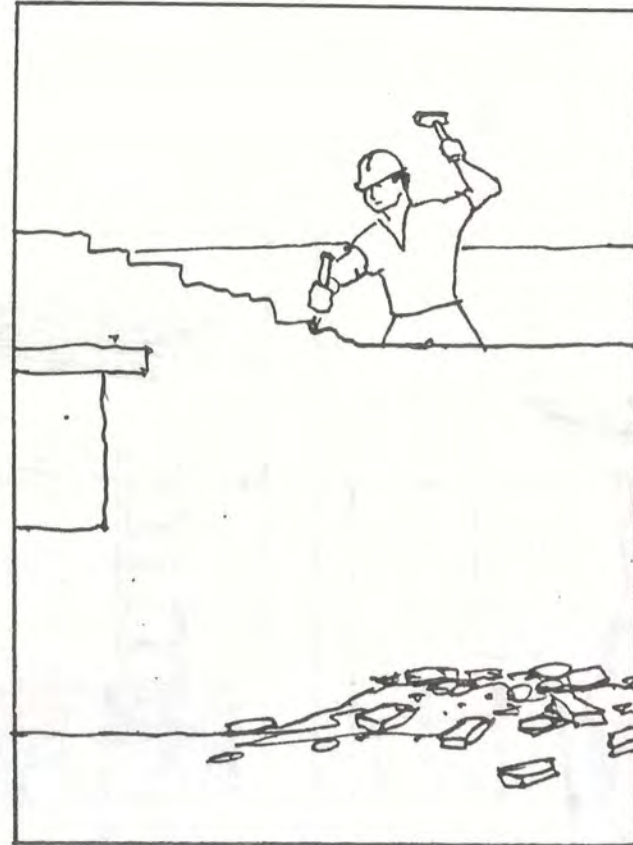

REDUZCA LA ALTURA DE LOS MUROS

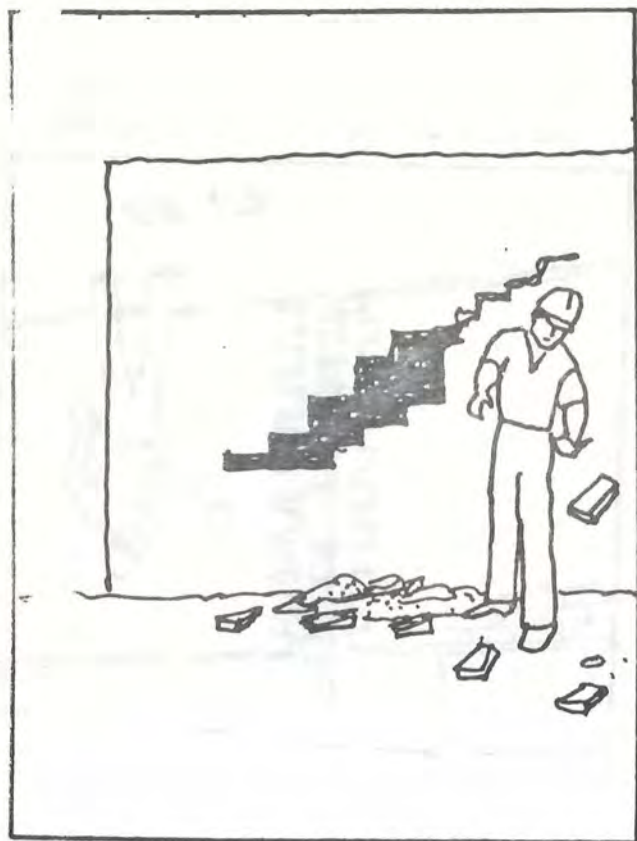

Retire los ladrillos del área marcada



Reconstruya la pared

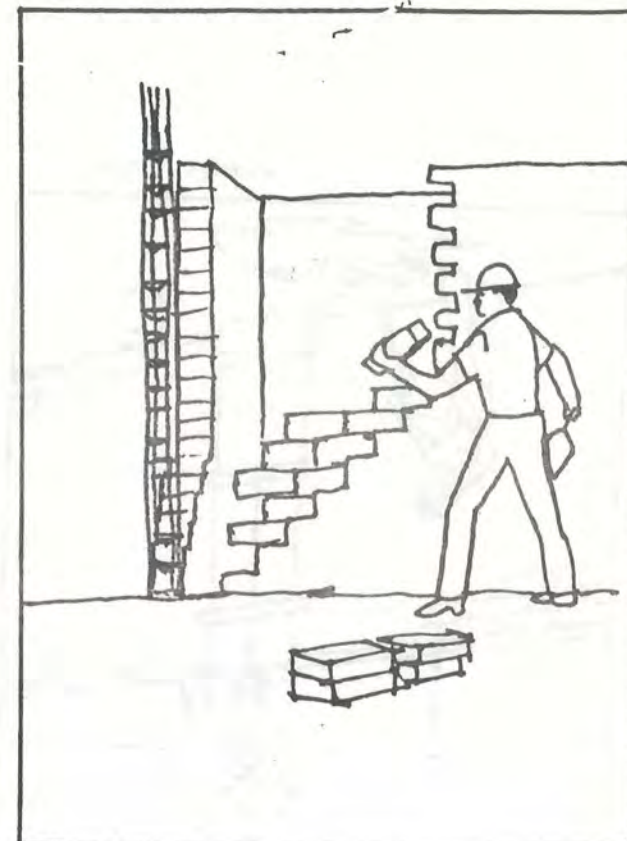

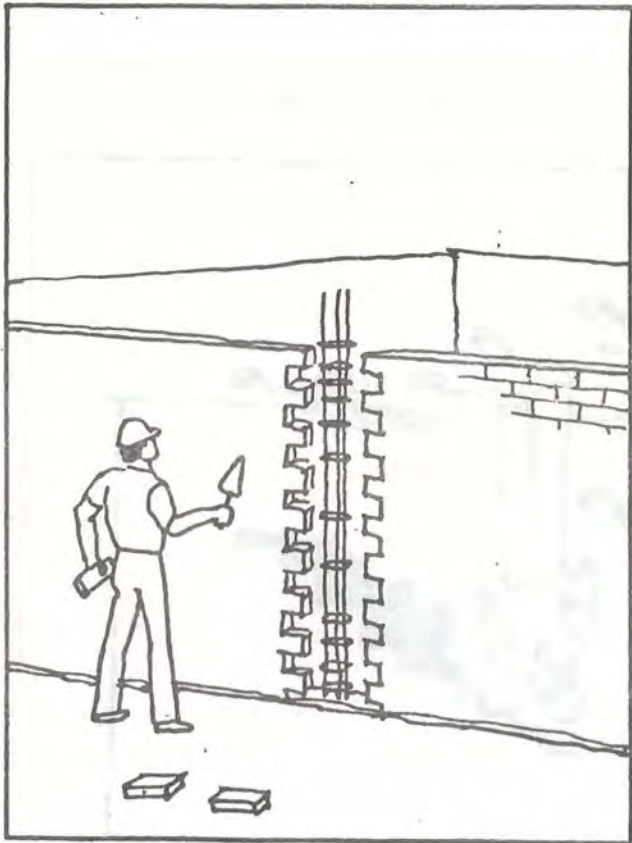

Verifique colocación correcta del castillo

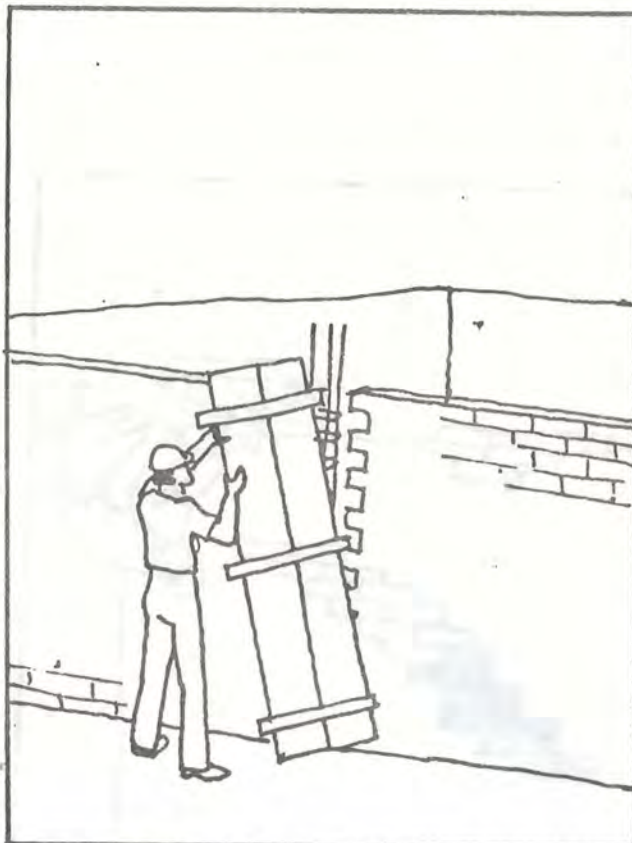

Coloque formaleta (encofre)

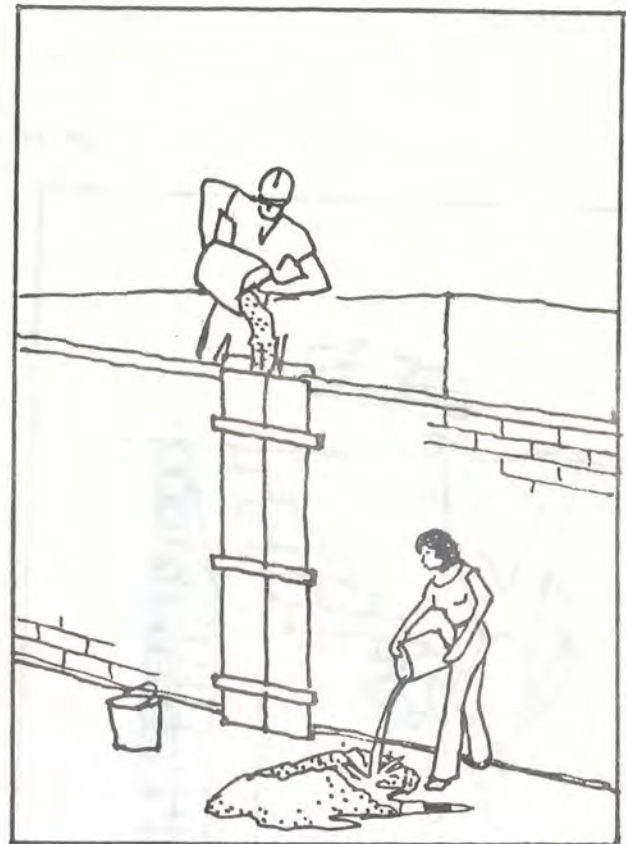

Funda columneta



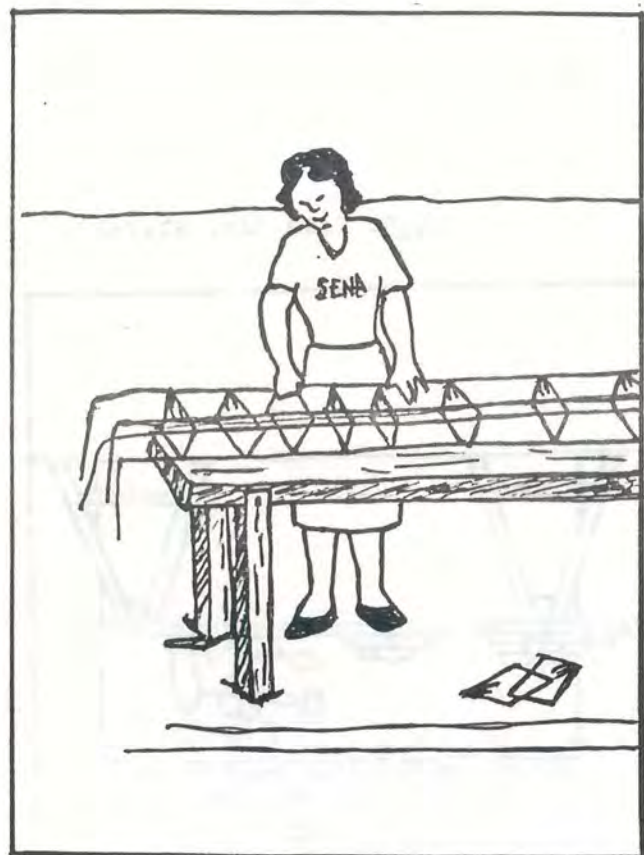

Construya armazón viga

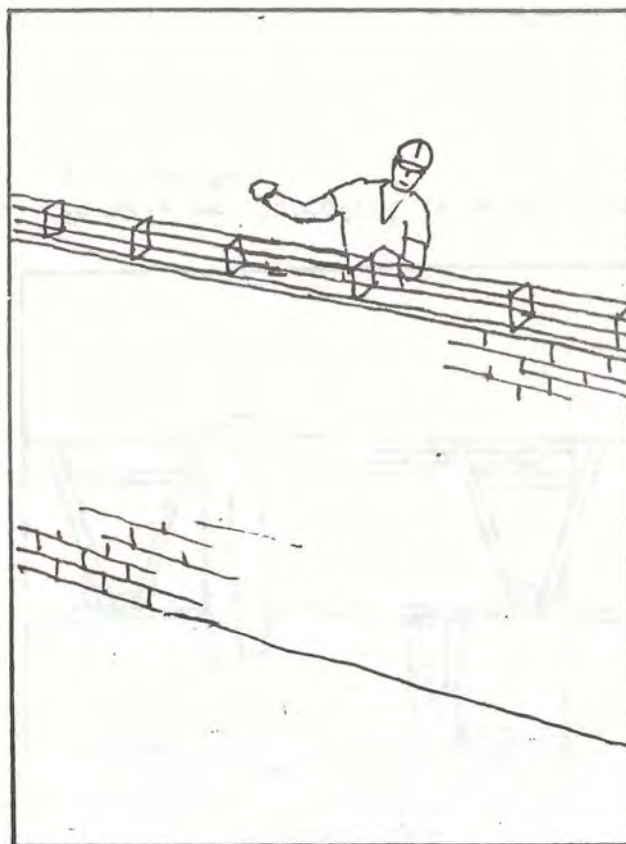

Coloque armazón sobre el muro

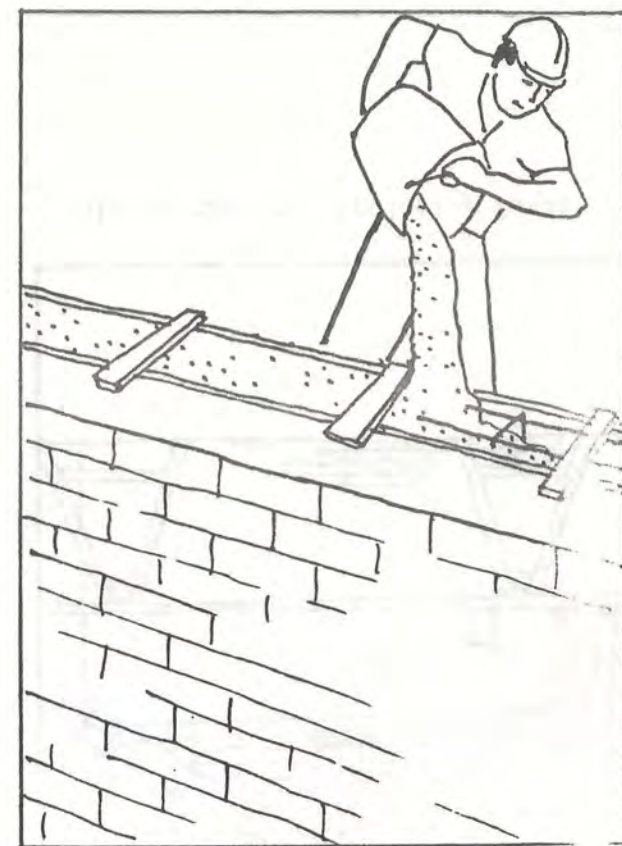

Funda viga superior (perimetral)

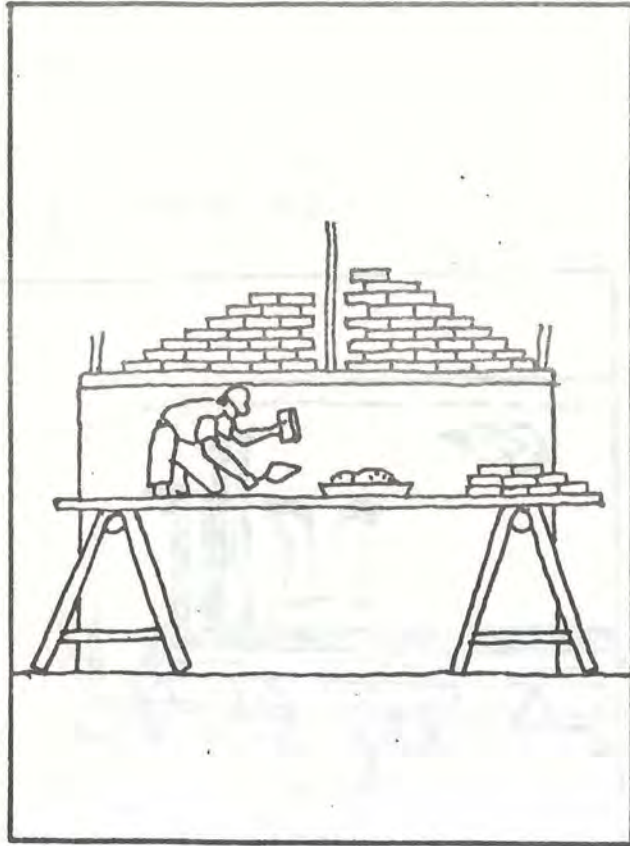

Levante muro para culata

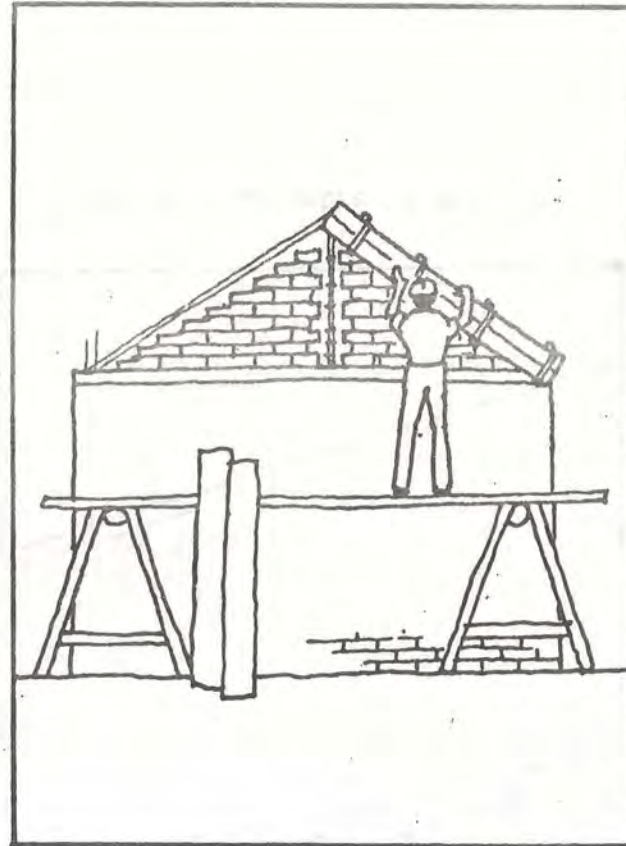

Formaletee (encofre) viga de corona y columneta

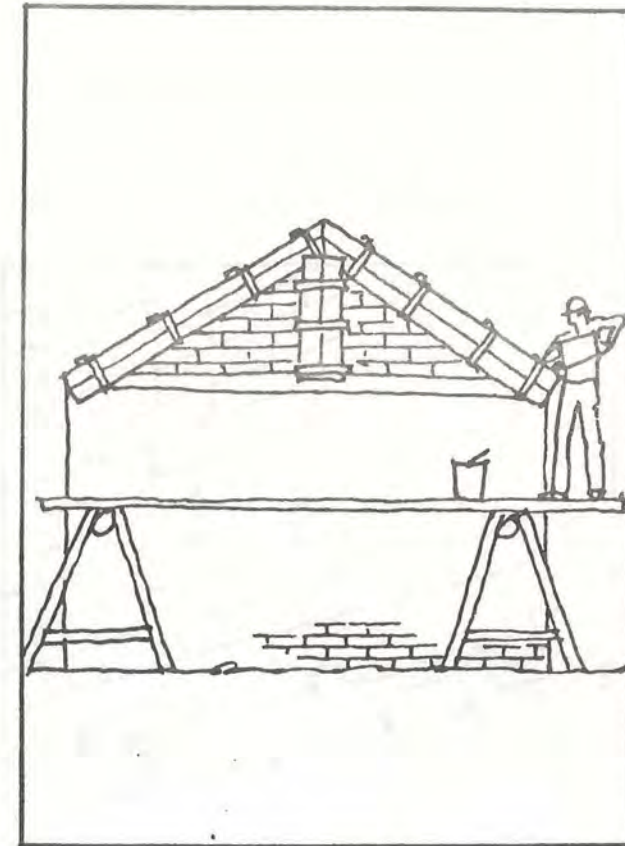

Coloque ganchos (pelos) y funda



Prepara madera

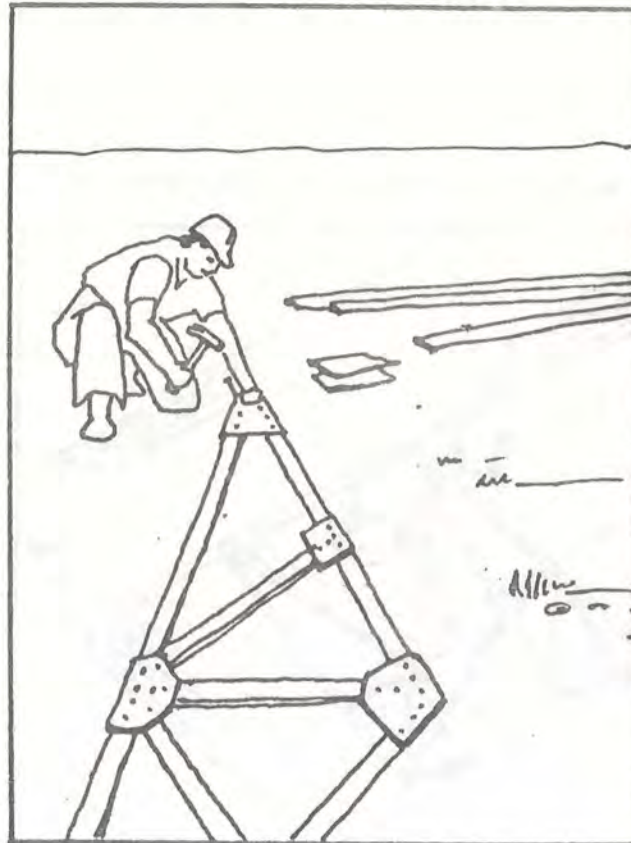

Arme Cercha

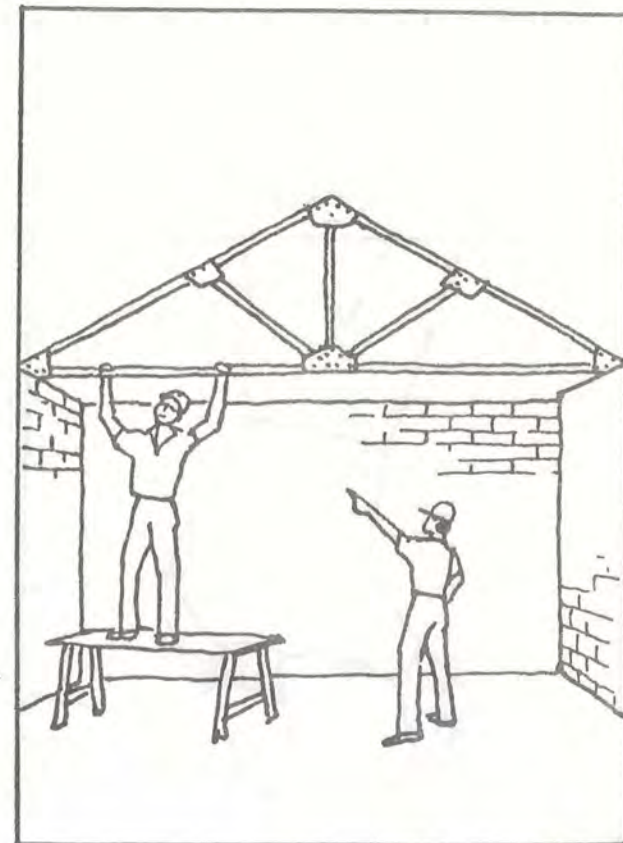

Coloque Cercha



Prepare madera

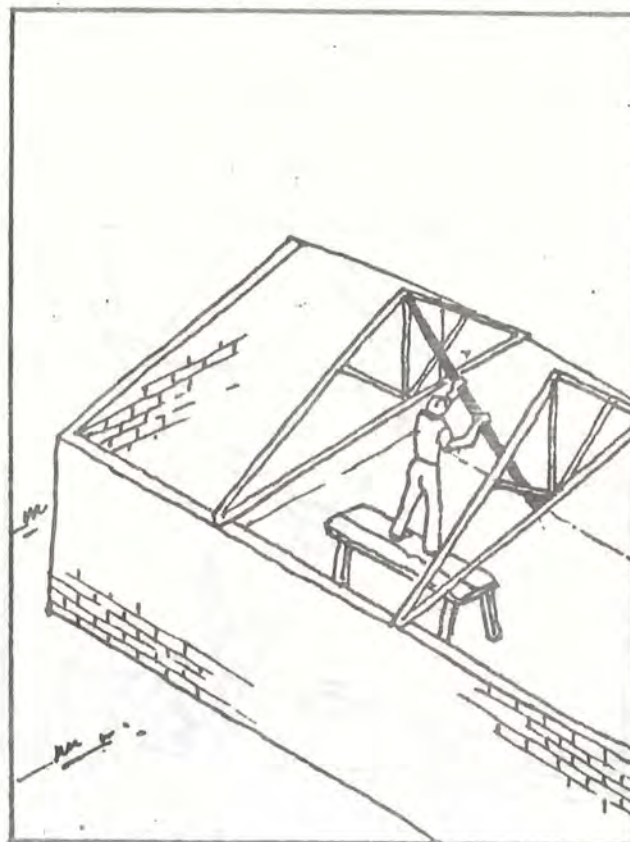

Coloque riostra (diagonal) entre cerchas



Fije riostra

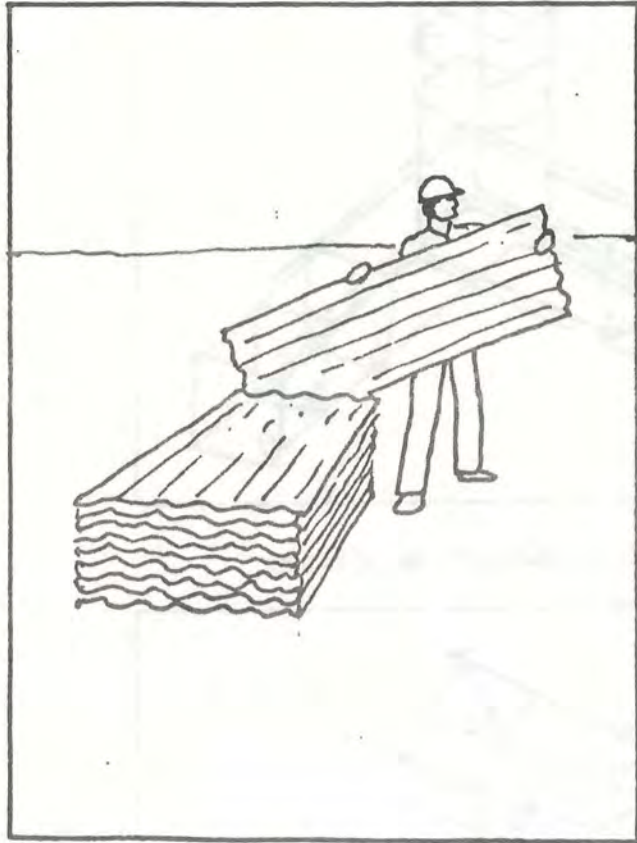

Aliste teja liviana

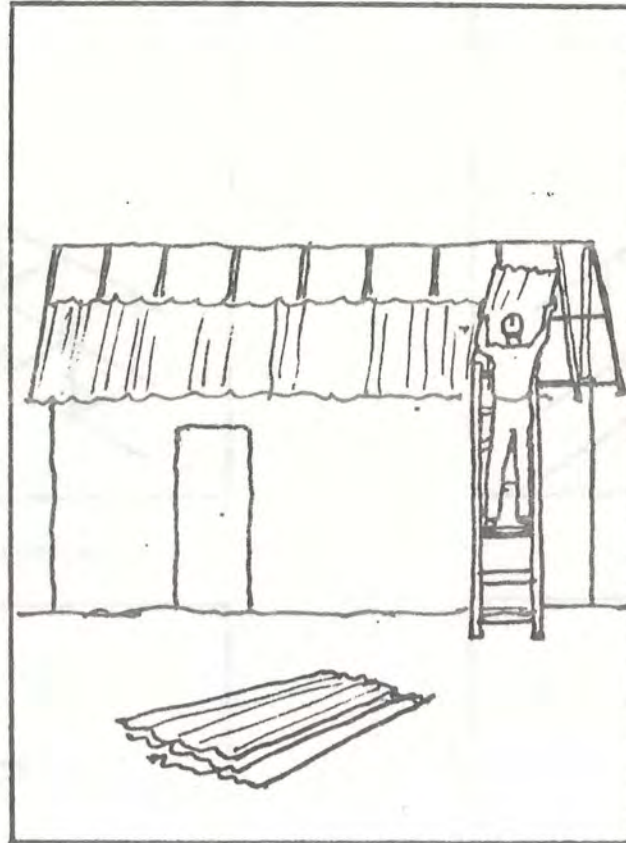

Coloque teja de abaja hacia arriba



Coloque caballetes

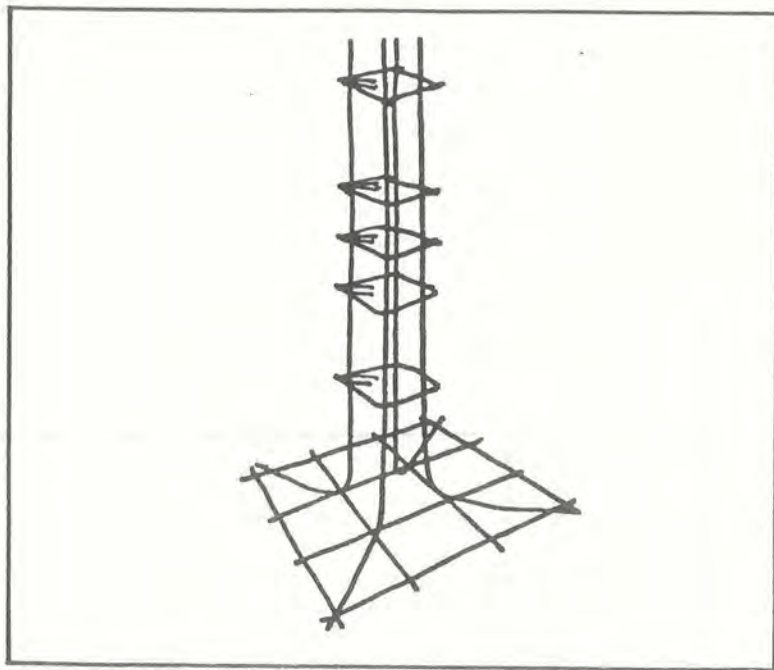

Anclaje de columnetas en zapata

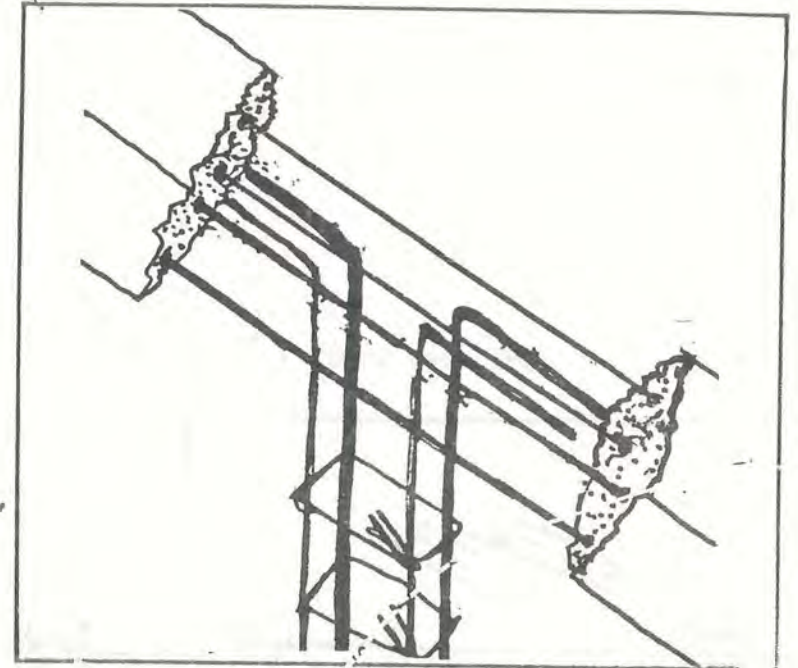

Anclaje de columneta nueva en viga existente

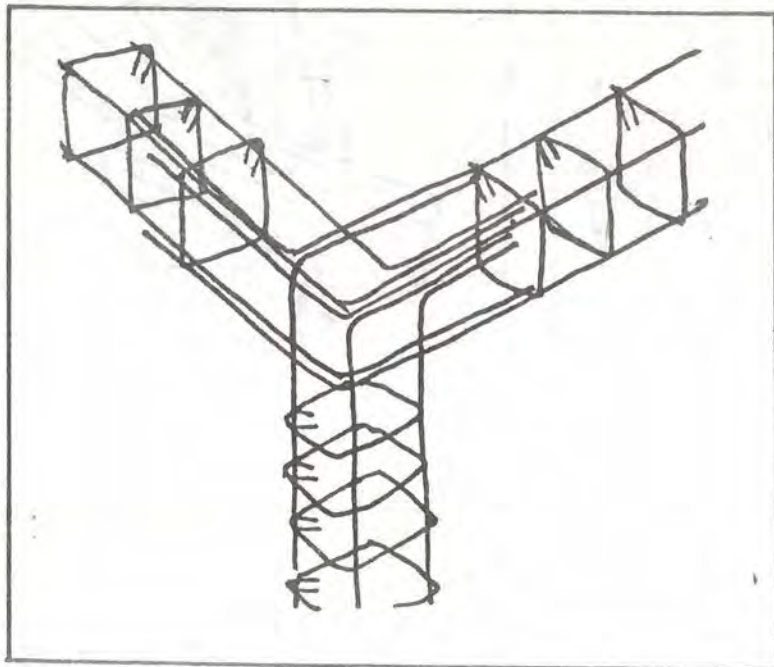

Unión de columneta con vigas de amarre en esquina

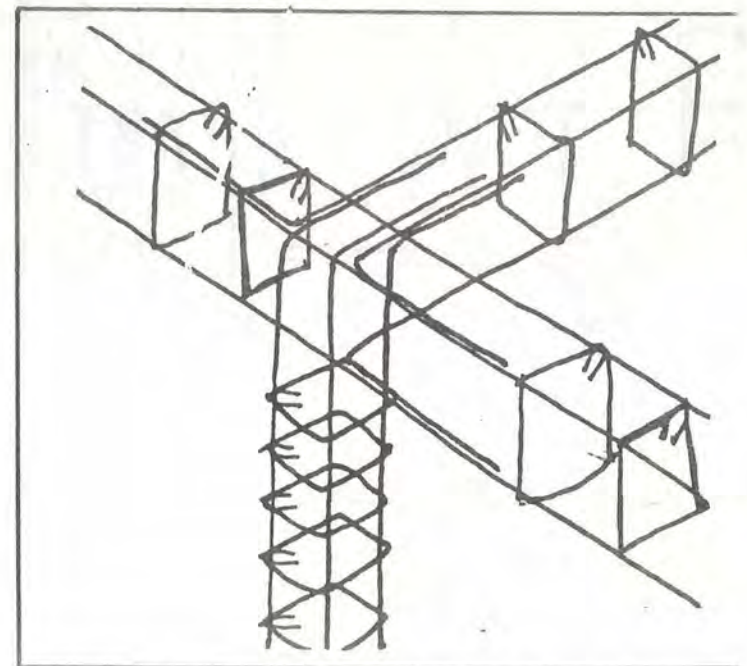

Unión de columneta con vigas de amarre en "T"